

CERTIFIED RECORD OF LAND CORNER MONUMENTS

History of original corner establishment:

Corner set by Charles Branson in 1898. No BTs .
Set 12x10x8" stone.
M. Whitmore found corner in 1961 and scribed 2 BTs.

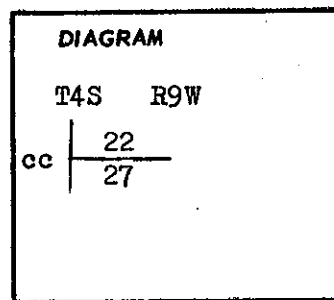

Description of corner evidence found:

Found a 10"x8"x6" stone with S22 on NE face and S27 on SE face.
Three notches on east edge and two notches on south edge. from which

A 20" fir brs. N26E 17.0 ft
face healed (M. Whitmore 2/11/61)

16" fir brs. S40W 7.0 ft
face healed (M. Whitmore 2/11/61)

NE corner Section 28 brs. North 53.5 feet marked by stone and brass cap

Description of monument and accessories established to perpetuate the original location of this corner

Set a 2"x30" iron pipe with brass cap marked

T4S R9W

cc $\frac{22}{27}$

1970
920

Set steel fence post 3 feet east of corner with attention sign facing south.

Painted strip on BTs. BT signs in place.

Set original stone beside brass cap.

Office of COUNTY SURVEYOR County of TILLAMOOK
State of OREGON, I hereby certify that the within instrument was filed in this office
for record on the 18th day of SEPTEMBER, 1970, at o'clock m., (signed)
[Signature] by County Surveyor
(COUNTY OFFICIAL) (DEPUTY)

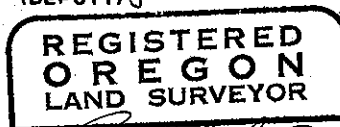

Richard L. Bryant
JULY 17, 1970
RICHARD L. BRYANT
920