

County Surveyor's Record, Tillamook County, Oregon

CHAINS

RESTORED CORNER FOR STATE OF OREGON--DEPARTMENT OF FORESTRY

Closing corner common to Sections 2 and 3, T3N, R10W,
W.M., Tillamook and Clatsop Counties, Oregon.

ORIGINAL

Post (now missing) from which a:

24" Hemlock bears S48 $\frac{1}{2}$ °E 37 lks.; now 43" uproot, roots in place,
scribes T3N R10W S2 visible on partially exposed face.

5" Hemlock bears S65W 26.5 lks.; now missing, a 4" fir log is
laying on top of where the BT remains should be.

40" Hemlock bears N 19.5 lks.; now 38" badly rotted stub, face and
scribes rotted away.

RESTORED

Var. 21 $\frac{1}{2}$ °E

Set 1 $\frac{1}{2}$ " x 36" galvanized iron pipe with 3" bronze cap marked "OREGON
STATE BOARD OF FORESTRY T4N R10W S34 S3 S2 T3N R10W CC 1969 RS
707", 30 inches in ground, in mound of rock, and from which a:

9" Hemlock bears S63°E 6.3 ft.; scribed T3N R10W CC S2 BT.

16" Hemlock bears N69°E 14.9 ft.; scribed T4N R10W CC S34 BT RS 707.

8" Hemlock bears S3W 26.9 ft.; scribed T3N R10W CC S3 BT.

Set 5" x 5" x 50" white painted Cedar post 1.0 ft. SE of corner pipe.

Oregon State Forestry Department metal location poster on 7" Hemlock
N79W 10.0 ft.

Dated March 31, 1969.

Restored by

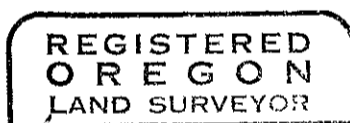

Harold J. Russell

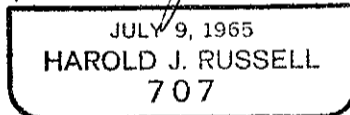

Present and witnessed by Larry Thompson.