

# County Surveyor's Record, Tillamook County, Oregon

CHAINS

RESTORED CORNER FOR STATE OF OREGON  
DEPARTMENT OF FORESTRY

Section corner common to Sections 25, 26, 35 and 36, Township 3 South, Range 7 West, Willamette Meridian, Tillamook County, Oregon.

ORIGINAL

Stone 18" x 12" x 6" (in place, 5 notches on North, 1 Notch on East)  
Did not find stone mound erected alongside by Frank Sharp, GLO surveyor, in 1894.

RESTORED

Var  $21\frac{1}{2}$  E

Marked X in top of original stone, drove nail in X, and erected mound of stone around same, from which a:

19" Fir bears N  $54\frac{3}{4}$  E 13.7 ft.; scribed T3S R7W S25 BT.  
13" Fir bears S 56 E 19.0 ft.; scribed T3S R7W S36 BT.  
11" Fir bears S  $14\frac{1}{2}$  W 10.5 ft.; scribed T3S R7W S35 BT.  
16" Fir bears N  $78\frac{1}{2}$  W 9.8 ft.; scribed T3S R7W S26 BT RS 707.  
Original line blazes found North and South of Corner.  
Corner is on a steep S 70 W slope.

Set 4" x 4" x 60" white painted Cedar post 1.5 ft. SE of corner stone.  
Oregon State Forestry Department metal location poster on 16" Fir BT.

Dated December 10, 1968.

Restored by

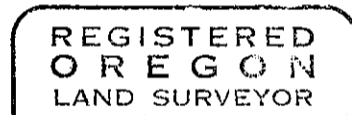

*Harold J. Russell*

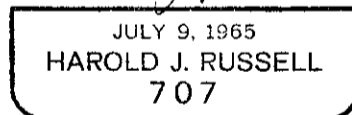

Present and witnessed by C. Curl  
J. Grace