

County Surveyor's Record, Tillamook County, Oregon

CERTIFIED RECORD OF LAND CORNER MONUMENTATION

(Reference FSH 5681.65)

History of original corner establishment:

This corner was established in 1956 by John C. Carlich (ORLS 287).

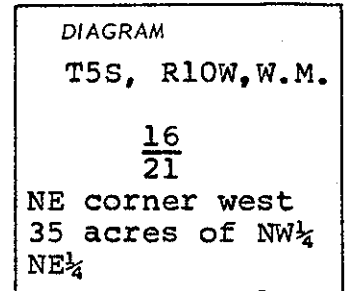

Description of corner evidence found:

Found a 1 inch iron rod for the corner from which:

A spruce, 39 inches in diameter bears S38W, 1.0 feet distance

A spruce, 46 inches in diameter bears N25 $\frac{1}{2}$ W, 85.5 feet distance

Description of monument and accessories established to perpetuate the original location of this corner

Because the iron rod was lodged in the roots of a tree and could not be removed. Set a 2 inch by 30 inch cement filled iron pipe due west 5.29 feet as a witness to the corner with a brass cap marked

T5S R10W

NE Cor

$$\frac{16}{21}$$

W.C.

1968

ORLS 650

U.S.F.S. bearing tree signs were placed on all BT's facing the true corner

Office of County Surveyor County of Tillamook
State of Oregon, I hereby certify that the within instrument was filed in this office
for record on the 1st day of August, 1968, at 2 o'clock p.m., (signed)
John C. Carlich by _____
(COUNTY OFFICIAL) (DEPUTY)

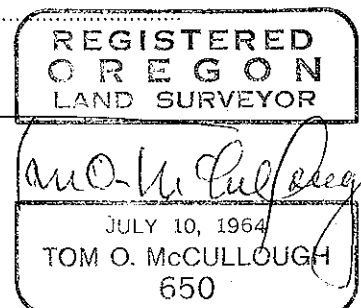

BOOK 3