

CHAINS

RESTORED CORNER FOR STATE OF OREGON--DEPARTMENT OF FORESTRY

One quarter corner common to Sections 7 and 18,
Township 1 South, Range 9 West, W. M., Tillamook
County, Oregon.

ORIGINAL

Post (missing) from which a:

- 32" Hemlock bears N 25E 105 lks.; roots remaining.
- 24" Hemlock bears S 23E 92 lks.; now 24" rotten stub 4' high,
face and scribes rotted away (now bears S12E).

RESTORATION by County Surveyor, 1887.

Post (missing) from which a:

- 24" Hemlock bears South 57 lks.; roots in place.
- 8" Hemlock bears N 64 W 42 lks.; now uprooted downhill, face
and scribes rotted away.

Note: This corner point checks the distance from the North
1/4 corner of Section 7 within 0.34' as returned by a
subdivision of Section 7 by H. P. Kerr in 1916.

RESTORED

Var 21 1/2 E

Set 1 1/2" x 36" galvanized iron pipe with 3" bronze cap marked
"OREGON STATE BOARD OF FORESTRY 1/4 S7 S18 1967 RS 707",
32 inches in ground, and from which a:

- 8" Hemlock bears S 85 1/2 W 18.4 ft.; scribed 1/4 S18 BT RS 707.
- 10" Hemlock bears N 29 E 47.3 ft. from face; scribed 1/4 S7 BT.

Set 4" x 4" x 50" white painted Cedar post 1.0 ft NW of corner pipe.
Oregon State Forestry Department metal location poster on 9" Fir
S 68 E 6.4.

Dated August 24, 1967.

Restored by

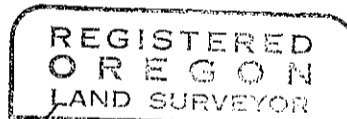

Harold J. Russell

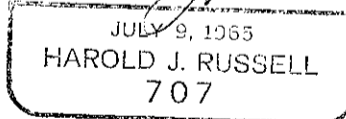

Present and witnessed by R. Morris