

County Surveyor's Record, Tillamook County, Oregon

PLAT OF RESTORATION OF 1/4 CORNER

A map illustrating the establishment of the 1/4 corner common to Sections 13 & 14, Township 4 South, Range 10 West of the Willamette Meridian, Tillamook County, Oregon.

Notes:

1. The bearings for this survey established by observation of Polaris.
2. This 1/4 corner was set in connection with the subdivision of Section 13 of above township and range. See Browning, Fultz & Steere Drawing No. 660004-1 for details.
3. The 1/4 corner is monumented with a one-inch galvanized iron pipe 3 1/2 feet long set 3 feet in the ground.
4. The fir snags shown were found at the bearings and distances recorded in the official GLO notes. The 36" snag is badly deteriorated and all marking is gone. The 56" snag has a discernible blaze with very faint marks.
5. Three property line fences meandering between trees corner on a maple tree about 10 feet from the monumented corner.

Set 4 October 1966 by L.E. Fultz

Witnessed by H. Hickman

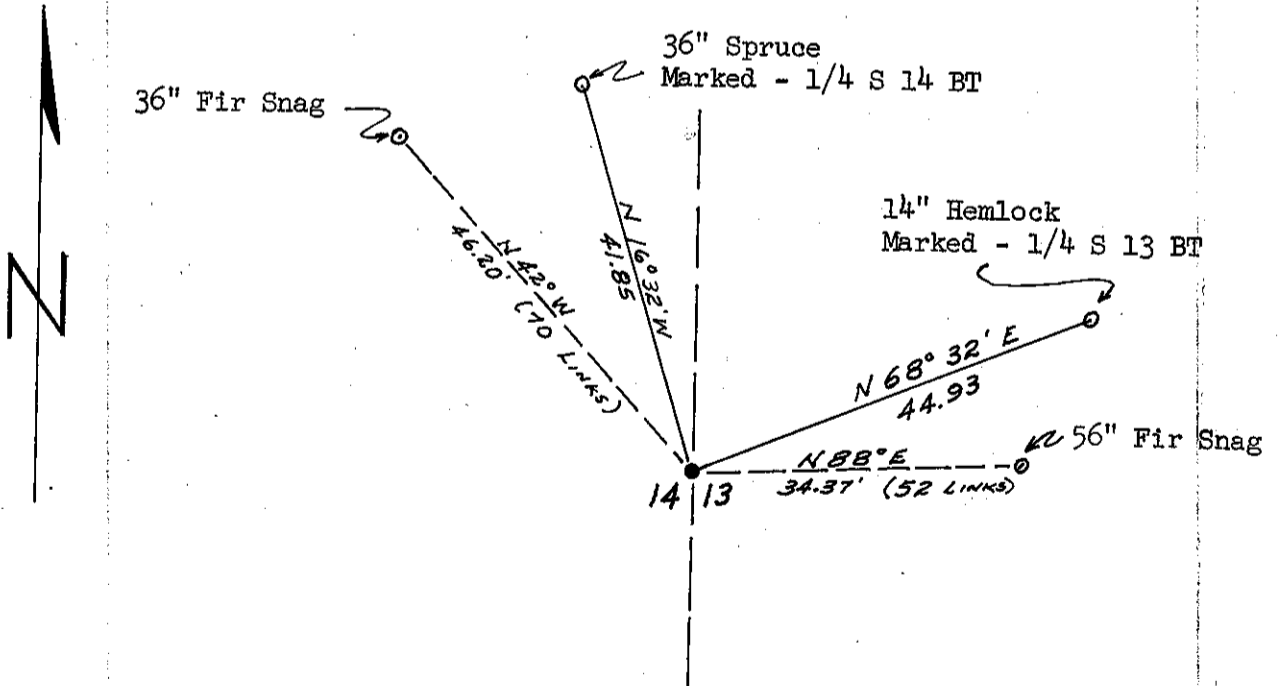

BOOK 3



DESIGN	BROWNING, FULTZ & STEERE, INC.	
	1913 NORTH HIGHWAY 101 LINCOLN CITY, OREGON	
DRAWN L.E.F.	Restoration of 1/4 Corner Section 13, Township 4 South, Range 10 West, Tillamook County, Oregon	
CHECKED	Page 54	
SCALE 1" = 20'	JOB NO. W.O. 6032	DWG. NO. 511 - 6600591
DATE 25 Nov 66		