

CHAINS

REWITNESSED CORNER FOR STATE OF OREGON--DEPARTMENT OF FORESTRY

One quarter corner common to Sections 9 and 16, Township 3 South, Range 7 West, W. M., Tillamook County, Oregon.

ORIGINAL

10" x 8" x 8" Stone (in place marks 1/4 visible on N. face), from which a:

- 6" V. Maple bears S  $73\frac{1}{2}$ ° E 21 lks.; now missing.
- 6" V. Maple bears N  $33\frac{1}{2}$ ° W 16 lks.; now missing.

REWITNESSED

Var  $21\frac{1}{2}$ ° E

Marked X in top of original cornerstone, in mound of rock, and from which a:

- 24" fir bears N  $7\frac{3}{4}$ ° W 73.3 ft.; scribed  $\frac{1}{4}$ " S9 BT RS 707.
- 17" Alder bears S  $43\frac{3}{4}$ ° W 24.9 ft.; scribed  $\frac{1}{4}$ " S16 BT. Elk Creek, 30 ft. wide, bears South 43 ft.

Set 4" x 4" x 50" white painted Cedar Post 1.0 ft. S. W. of cornerstone. Oregon State Forestry Department metal location poster on 17" Alder BT. Also poster on East edge Elk Creek, N  $89^{\circ} 48'$  E 396.9 ft.

Dated: May 19, 1966

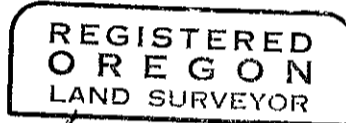

Rewitnessed by

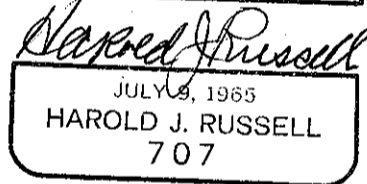

Present and witnessed by C. Curl  
B. Seeley