

CHAINS

RESTORED CORNER FOR STATE OF OREGON-DEPARTMENT OF FORESTRY

Section corner common to Sections 7, 8, 17 and 18, T3N, R9W, W.M., Tillamook County, Oregon.

ORIGINAL

Post (now missing) from which a:

- 12" Hem. bears S40°E 16 lks.; roots in place.
- 14" Hem. bears S18°W 30 lks.; now 15" rotten stub 7 ft. high, scribes and backcast on ground (now bears S1 3/4°W).
- 10" Hem. bears N2°E 22 lks.; now mound of rotten wood in place.
- 44" Fir bears N50°W 22 lks.; now 60" stump, scribes BT on exposed lower face, upper face cut off when logged.

RESTORED

Set 1 1/2" x 36" galvanized iron pipe with 3" bronze cap marked "OREGON STATE BOARD OF FORESTRY T3N R9W S7 S8 S17 S18 1965 RS 401", 33 inches in ground, and from which a:

- 17" Fir bears N55 3/4°W 9.4 ft.; scribed T3N R9W S7 BT.
- 15" Fir bears S72 1/4°W 21.5 ft.; scribed T3N R9W S18 BT.
- 19" Fir bears S16 1/2°E 11.0 ft.; scribed T3N R9W S17 BT RS401.
- 13" Fir bears N76 3/4°E 18.3 ft.; scribed T3N R9W S8 BT.

Set 4" x 4" x 60" white painted Cedar post 0.9 ft. NE of corner pipe. Oregon State Forestry Department metal location poster on 19" BT.

Dated June 9, 1965

Restored by Harold J. Russell under my direction.
Harold J. Russell, Transitman

Present and witnessed by A. Duncan
C. Curl

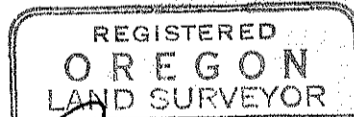

Richard A. Morris
MAY 10. 1957
Richard A. Morris
401