

CHAINS

REWITNESSED CORNER FOR STATE OF OREGON-DEPARTMENT OF FORESTRY

Line Tree common to Sections 8 and 9, T2N, R9W, W.M.,
Tillamook County, Oregon.

ORIGINAL

32" Cedar Line tree at 68.00 chains (now 71" stump, 3 notches remaining on
N. side).

REWITNESSED

7" Fir bears S55W 15.7 ft.; scribed AP S8 BT.
17" Fir bears N42 $\frac{1}{2}$ E 22.2 ft.; scribed AP S9 BT RS401.

Oregon State Forestry Department metal location poster on North side of
Cedar line tree.

Dated December 31, 1963

Restored by

~~Richard Morris, Transitman~~
Richard Morris, Transitman

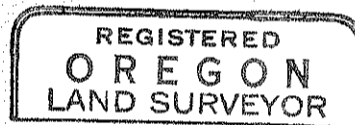

Richard A. Morris

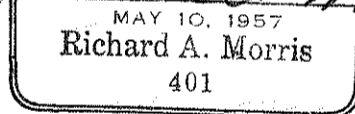

Present and witnessed by L. Hayes