

CHAINS

RESTORED CORNER FOR OREGON STATE BOARD OF FORESTRY

Section corner common to Sections 25 and 36, T1S, R8 & 9W, W.M., Tillamook County, Oregon.

*(EAST END) O.E.D., C.S. 3/13/85*

ORIGINAL

Stone 18 x 8 x 7 (found in place, 5 notches on N. and 1 notch on S. face) from which a:

- 24" Spruce bears N87W 78 lks.; now 30" rotted stub.
- 4" Alder bears S42°30'W 79 lks.; now missing.

RESTORED

Var. 21 1/2 E

Erected mound of rock around original corner stone from which a:

- 17" Hemlock bears N72W 21.4 ft.; scribed T1S R9W S25 BT RS526.
- 18" Spruce bears S29W 43.3 ft.; scribed T1S R9W S36 BT.

Set 4 x 4 x 72" white painted Cedar post 2.0 ft. S.W. of corner stone.

Oregon State Board of Forestry metal location poster on 12" Spruce N25W 16.1 ft.

Dated May 9, 1961

Restored by

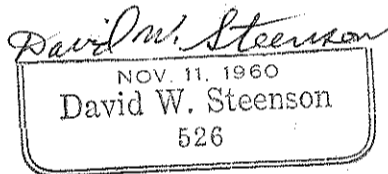
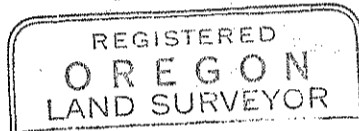

Present and witnessed by H. Baughn