

CHAINS

ESTABLISHED CORNERS FOR OREGON STATE BOARD OF FORESTRY
(See official plat)

South One-sixteenth corner common to Sections 9 and
10, T1N, R10W, W.M., Tillamook County, Oregon.

ESTABLISHED

Var. 21 1/2 E

Set 1 1/2" x 36" galvanized iron pipe with 3" bronze cap marked "OREGON STATE
BOARD OF FORESTRY S 1/16 S9 S10 1961 RS401", 34 inches in ground, and
from which a:

- 28" Fir bears S81 1/2 W 20.9 ft.; scribed S 1/16 S9 BT RS401.
- 19" Hemlock bears S55 1/2 E 7.8 ft.; scribed S 1/16 S10 BT.

Set 4" x 4" x 52" white painted Cedar post 1.0 ft. N.E. of corner pipe.
Oregon State Board of Forestry metal location poster on 20" Hemlock
S2E 6.8'.

* * * * *

West One-sixteenth corner common to Sections 10 and
15, T1N, R10W, W.M., Tillamook County, Oregon.

ESTABLISHED

Var. 21 1/2 E

Set 1 1/2" x 36" galvanized iron pipe with 3" bronze cap marked "OREGON STATE
BOARD OF FORESTRY W 1/16 S10 S15 1961 RS401", 34 inches in ground, in
mound of rock, and from which a:

- 24" Hemlock bears S29E 32.4 ft.; scribed W 1/16 S15 BT RS401.
- 18" Hemlock bears N79 1/2 W 43.2 ft.; scribed W 1/16 S10 BT.

Set 4" x 4" x 52" white painted Cedar post 1.0 ft. S.E. of corner pipe.
Oregon State Board of Forestry metal location poster on 24" Hemlock BT.

Dated February 27, 1960

Established by

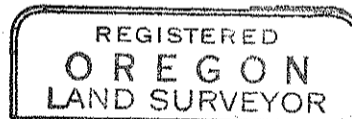

Richard A. Morris

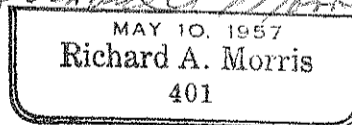

Present and witnessed by H. Russell
R. Cop
E. Nylund