

CHAINS

RESTORED CORNER FOR OREGON STATE BOARD OF FORESTRY

One Quarter corner common to Sections 7 and 8, T. 3S., R. 7W., W.M., Tillamook County, Oregon

ORIGINAL

Post (Missing) from which a:

12" Hemlock bears N.32°E. 21 lks.; now 23" uproot, roots and root hole in place, scribes 1/4 visible on partly exposed face.

10" Hemlock bears S.16½°W. 24 lks.; now 24" stub 2' high, scribes BT visible.

RESTORED

Var. 21½° E.

Set 1½" x 36" galvanized iron pipe with 3" bronze cap marked "OREGON STATE BOARD OF FORESTRY 1/4 S7 S8 1957 RS359," 35 inches in ground, in mound of stone, and from which a:

6" Hemlock bears N.51°E. 37.8 ft.; scribed 1/4 S8 BT.

72" Fir stump bears N.43°W. 8.2 ft.; scribed 1/4 S7 BT RS359.

Oregon State Board of Forestry metal location poster on 6" Hemlock BT. Set 3" x 3" x 60" white painted Cedar post 2' S.E. of pipe.

Dated April 24, 1957

Restored by Richard Morris under my direction.  
Richard Morris, Transitman

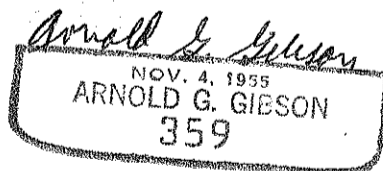
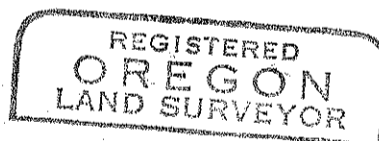

Present and witnessed by Robert Sturm  
Lloyd Geraths  
Millard Trout