

CHAINS

RESTORED CORNER FOR OREGON STATE BOARD OF FORESTRY

One quarter corner common to Sections 7 and 18, T. 2S., R. 6W., W.M., Tillamook County, Oregon.

ORIGINAL

(No mention of post or stone) from which a:

42" Fir bears N.20°E. 48 lks.; now 44" stump, original face and axe mark uncovered, partly burnt.

24" Hemlock bears S.30°E. 18 lks.; now 30", down, rotted and burnt.

RESTORED

Var. 21½°

Set 1½" x 36" galvanized iron pipe with 3" bronze cap marked "OREGON STATE BOARD OF FORESTRY 1/4 S7 S18 1957 RS359," 30 inches in ground on north edge of cat road, in mound of stone, and from which a:

42" stump (original) bears N.20°E. 31.7 ft.; scribed 1/4 S7 BT RS359 (below old face)

68" Fir stump bears S.18°E. 27.6 ft.; scribed 1/4 S18 BT.

Oregon State Board of Forestry metal location poster on 50" x 6" high Fir stub N.72°E. 22.5'

Dated April 30, 1957

Restored by Arnold G. Gibson

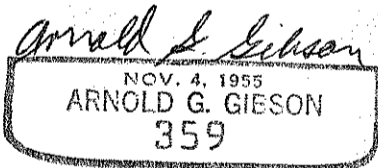
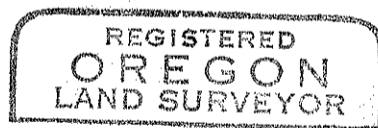

Present and witnessed by David Steenson  
Elbert Driver  
Gerald Schwalen