

CHAINS

ESTABLISHED CORNERS FOR STATE OF OREGON-DEPARTMENT OF FORESTRY  
(See official plat)  
Center East One-sixteenth corner for Section 8, T1S, R8W,  
W.M., Tillamook County, Oregon.

ESTABLISHED

Var. 21 1/2 E

Set 1 1/2" x 36" galvanized iron pipe with 3" bronze cap marked "OREGON STATE  
BOARD OF FORESTRY E 1/16 C—C S8 1962 RS401", 32 inches in ground, and  
from which a:

- 30" Spruce bears N81E 9.5 ft.; scribed CE 1/16 S8 BT RS401.
- 54" Double Hemlock bears S64W 7.5 ft.; scribed CE 1/16 S8 BT.

Corner is approximately 100' North of center line Wilson River Highway.  
Set 4" x 4" x 52" white painted Cedar post 1.0 ft. NW of corner pipe.  
Oregon State Forestry Department metal location poster on 30" Hemlock BT.

\*\*\*\*\*

Center One Quarter corner for Section 8, T1S, R8W, W.M.,  
Tillamook County, Oregon.

ESTABLISHED

Var. 21 1/2 E

Set 1 1/2" x 36" galvanized iron pipe with 3" bronze cap marked "OREGON STATE  
BOARD OF FORESTRY C 1/4 S8 1962 RS401", 32 inches in ground, and from  
which a:

- 26" Fir bears N57E 46.1 ft.; scribed C 1/4 S8 BT RS401.
- 27" Fir bears S24E 63.7 ft.; scribed C 1/4 S8 BT.

Set 4" x 4" x 52" white painted Cedar post 1.0 ft. NW of corner pipe.  
Oregon State Forestry Department metal location poster on 4" Fir N47W  
20.4 ft.

Dated June 27, 1962

Established by B. Davis under my direction.  
B. Davis, Transitman

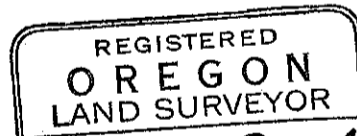

*Richard A. Morris*  
MAY 10. 1957  
Richard A. Morris  
401

Present and witnessed by D. Fletcher  
C. Curl

*Cor. E 1/16  
8-1-S-8.*

*Cor. 1/4  
8-1-S-8.*