

CHAINS

ESTABLISHED CORNERS FOR STATE OF OREGON-DEPARTMENT OF FORESTRY
(See official plat)

Center One Quarter corner for Section 22, T2S, R9W, W.M.,
Tillamook County, Oregon.

ESTABLISHED

Var. 21 1/2 E

Set 1 1/2" x 36" galvanized iron pipe with 3" bronze cap marked "OREGON STATE
BOARD OF FORESTRY C 1/4 S22 1961 RS401", 36 inches in ground, and from
which a:

40" Double Spruce bears S59E 234.5 ft.; scribed C 1/4 S22 BT.
12" Spruce bears N7 1/2 W 64.8 ft.; scribed C 1/4 S22 BT RS401.

Set 4" x 4" x 52" white painted Cedar post 1.0 ft. SE of corner pipe.
Oregon State Forestry Department metal location poster on 40" Spruce BT.

Established by

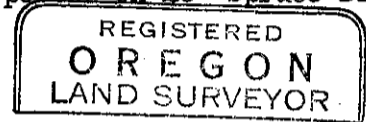

Present and witnessed by E. Nylund, J. Sehorn

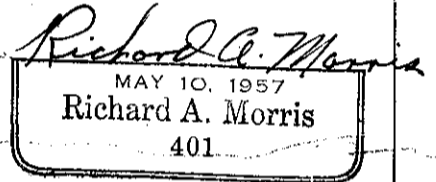

Center North One Sixteenth corner for Section 22, T2S,
R9W, W.M., Tillamook County, Oregon.

ESTABLISHED

Var. 21 1/2 E

Set 1 1/2" x 36" galvanized iron pipe with 3" bronze cap marked "OREGON STATE
BOARD OF FORESTRY N 1/16 C---C S22 1961 RS401", 32 inches in ground,
and from which a:

12" Hemlock bears N50 1/2 E 63.5 ft.; scribed CN 1/16 S22 BT RS401.
11" Hemlock bears N32W 115.7 ft.; scribed CN 1/16 S22 BT.

Set 4" x 4" x 52" white painted Cedar post 1.2 ft. SE of corner pipe.
Oregon State Forestry Department metal location poster on 12" Hemlock BT.

Dated November 9, 1961

Established by Harold J. Russell under my direction.
Harold Russell, Eng. Technician I

Present and witnessed by E. Nylund
A. Duncan
D. Spiesschaert

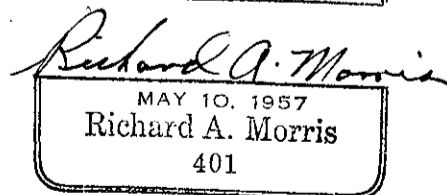
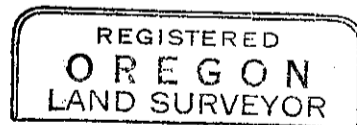

Center 1/4 S22
22-21 1/2 E

Center N 1/16
22-21 1/2 E