

CHAINS

RESTORED CORNER FOR STATE OF OREGON-DEPARTMENT OF FORESTRY

Section corner common to Sections 19 and 30 (West end),
T2S, R3W, W.M., Tillamook County, Oregon.

ORIGINAL

Post (now missing) from which a:

- 7" Spruce bears N76°E 51 lks.; now missing.
- 24" Spruce bears S82°E 38 lks.; now 24" stub 8' high, scribes S8W S on face, and scribes rotted away.
rest of face

RESTORED

Var. 21°30'E

Set 1 1/2" x 36" galvanized iron pipe with 3" bronze cap marked "OREGON STATE BOARD OF FORESTRY T2S R9W R3W S25 S19 S30 1962 RS401", 33 inches in ground, in mound of stone, and from which a:

- 9" Cedar bears N17°W 158.0 ft.; scribed T2S R9W S25 BT.
- 9" Hemlock bears N24°E 188.8 ft.; scribed T2S R3W S19 BT RS401.

Rock outcrop, south side of road, bears S17 1/2°E 49.8 ft.; marked B0 X.

Oregon State Forestry Department metal location poster on 24" Hemlock stump N70°E 25.6 ft.

Also poster on white post South 13.3 ft. on North edge of road.

Set 4" x 4" x 52" white painted Cedar post 1.0 ft. SE of corner pipe.

Dated October 25, 1962

Restored by Harold J. Russell under my direction.
Harold J. Russell, Eng. Technician

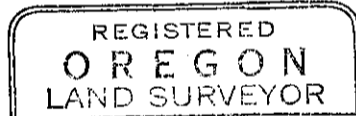

Present and witnessed by D. Spiesschaert
C. Curl

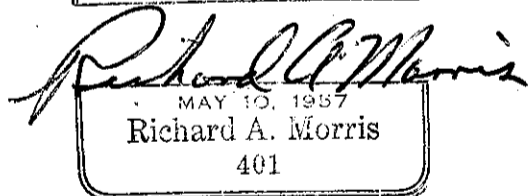

S.W. Cor 19
2. S. 8.

545