

E. 1/16 S. 10.
3-3-10

CHAINS

ESTABLISHED CORNERS FOR STATE OF OREGON-DEPARTMENT OF FORESTRY
(See official plat)
East One-sixteenth corner common to Sections 3 and 10, T3S,
R10W, W.M., Tillamook County, Oregon.

ESTABLISHED

Var. 21 1/2 E

Set 1 1/2" x 36" galvanized iron pipe with 3" bronze cap marked "OREGON STATE
BOARD OF FORESTRY E 1/16 S3 S10 1962 RS401", 34 inches in ground, and
from which a:

- 6" Hemlock bears S59W 8.8 ft.; scribed E 1/16 S10 BT.
- 9" Hemlock bears N13 1/2 E 43.2 ft.; scribed E 1/16 S3 BT RS401.

Spring Branch 46.0 ft. West of corner, course S60W.

Set 4" x 4" x 52" white painted Cedar post 1.0 ft. SW of corner pipe.
Oregon State Forestry Department metal location poster on 15" Alder
S60E 1.2 ft.

Present and witnessed by J. Sehorn, D. Fletcher and C. Curl

* * * * *

North One-sixteenth corner common to Sections 10 and 11,
T3S, R10W, W.M., Tillamook County, Oregon.

ESTABLISHED

Var. 21 1/2 E

Set 1 1/2" x 36" galvanized iron pipe with 3" bronze cap marked "OREGON STATE
BOARD OF FORESTRY N 1/16 S10 S11 1962 RS401", 33 inches in ground, and
from which a:

- 24" Fir bears East 9.9 ft.; scribed N 1/16 S11 BT RS401.
- 29" Double Hemlock bears N36 1/2 W 7.7 ft.; scribed N 1/16 S10 BT.

Corner pipe is in North and South fence, 26.3 ft. South of fence
corner from which fence runs South and East.

6" Creek 22.0 South of corner, course S50W.

Set 4" x 4" x 52" white painted Cedar post 1.1 ft. SE of corner pipe.
Oregon State Forestry Department metal location poster on 24" Fir BT.

Present and witnessed by D. Fletcher & C. Curl

Dated July 13, 1962

Established by Harold J. Russell under my direction.
Harold Russell, Engineer Tech. I

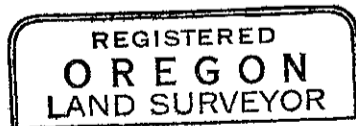

Richard A. Morris
MAY 10, 1957
Richard A. Morris
401

157