

CHAINS

RESTORED CORNER FOR OREGON STATE BOARD OF FORESTRY

One Quarter corner common to Sections 27 and 34,
T2N, R8W, W.M., Tillamook County, Oregon.

ORIGINAL

Basalt stone 17" x 12" x 6" (now missing) from which a:

60" Fir bears N55W 8 lks.; now 48" snag, scribes 4 BT visible, rest
burnt away.

48" Fir bears S40E 37 lks.; now 42" snag, face burned away.

RESTORED

Var. 21 $\frac{1}{2}$ E

Set 1 $\frac{1}{2}$ " x 36" galvanized iron pipe with 3" bronze cap marked "OREGON STATE
BOARD OF FORESTRY 1/4 S27 S34 1959 RS401", 34 inches in ground, in mound
of stone, and from which a:

45" Fir snag bears S42W 8.2 ft.; scribed 1/4 S34 BT RS401.

36" Fir snag bears N80 $\frac{1}{2}$ E 69.4 ft.; scribed 1/4 S27 BT.

Oregon State Board of Forestry metal location poster on 45" Fir snag BT.

Set 4" x 4" x 48" white painted Cedar post 1.4 ft. S.W. of pipe.

Dated August 4, 1959

Restored by Harold J. Russell under my direction.
Harold Russell, Eng. Tech. 1

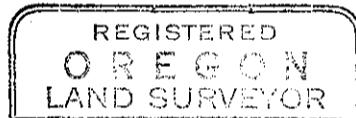

Richard A. Morris

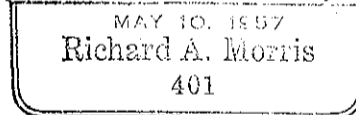

Present and witnessed by E. Nylund
D. Jones