

CHAINS

RESTORED CORNER FOR OREGON STATE BOARD OF FORESTRY

One Quarter corner common to Sections 12 and 13,
T. 3S, R. 7W, W.M., Tillamook County, Oregon.

ORIGINAL

Stone, 12" x 10" x 6" (now in place with marks 1/4 visible on N. face).

RESTORED

Var. 21 1/2 E

Erected mound of stone around original 1/4 corner stone from which a:

20" Fir bears N1E 6.5 ft.; scribed 1/4 S12 BT.

22" Fir bears S23 1/2 W 39.6 ft.; scribed 1/4 S13 BT RS401.

Oregon State Board of Forestry metal location poster on 22" Fir BT.

Set 4" x 4" x 48" white painted Cedar post 1.5' S.E. of cornerstone.

Dated September 23, 1958

Restored by Robert Sturm under my direction.
Robert Sturm, Compassman

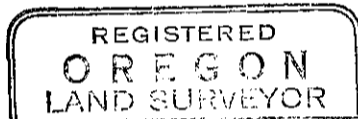

Richard A. Morris
MAY 10, 1957
Richard A. Morris
401

Present and witnessed by Harold Russell
Ronald Schulson