

County Surveyor's Record, Tillamook County Oregon

CHAINS

RESTORED CORNER FOR OREGON STATE BOARD OF FORESTRY

One Quarter corner common to Sections 2 and 11, T1N, R7W, W.M., Tillamook County, Oregon.

ORIGINAL

Post (now missing, found bent over 3/4" x 5" iron pipe in place) from which a:

- 5" Maple bears N51E 10 lks.; now missing, Vine Maple clumps growing in vicinity.
- 12" Hemlock bears S6E 21 lks.; now 18" stub 3' high, scribes BT visible, rest missing.

RESTORED by W. E. Anderson March 8, 1932

Set 3" x 3" Fir stake (now missing) from which a:

- 36" Hemlock bears N38W 19.0 ft.; now 28" stump, face and scribes burnt off.

RESTORED

Set 1 1/2" x 36" galvanized iron pipe with 3" bronze cap marked "OREGON STATE BOARD OF FORESTRY 1/4 S2 S11 1958 RS401," 33 inches in ground, in mound of stone, and from which a:

- 22" Fir stump bears N9E 141.3 ft.; scribed 1/4 S2 BT RS401.
- 42" Fir stump bears S13W 119.5 ft.; scribed 1/4 S11 BT.

Oregon State Board of Forestry metal location poster on 42" Fir stump BT.
Set 2" x 4" x 60" white painted cedar post 1.3' N. E. of pipe.
Set old pipe along side new one.

Dated May 12, 1958.

Restored by

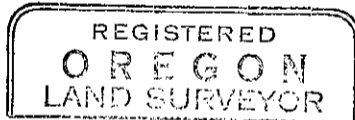

Richard A. Morris

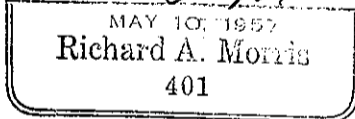

Present and witnessed by Robert Sturm
Harold Russell

Book I