

CHAINS

RESTORED CORNER FOR OREGON STATE BOARD OF FORESTRY

One Quarter corner common to Sections 8 and 17
T. 1S, R. 7W, W.M., Tillamook County, Oregon.

ORIGINAL

Post (now missing, found trace of rotted point in ground) from which a:

- 16" Hemlock bears North 16 lks.; now 20" stub 4' high, scribes BT visible, upper face burnt out.
- 75" Spruce bears S14°E 46 lks.; now 80" snag, scribes BT visible, upper face unexposed.

RESTORED

Var. 21½°E

Set 1½" x 36" galvanized iron pipe with 3" bronze cap marked "OREGON STATE BOARD OF FORESTRY 1/4 S8 S17 1957 RS401," 33 inches in ground, and from which a:

- 7" Fir bears S69½°W 7.4 ft.; scribed 1/4 S17 BT RS401.
- 6" Fir bears N27°W 43.8 ft.; scribed 1/4 S8 BT.

Oregon State Board of Forestry metal location poster on 7" Fir BT.
Set 4" x 4" x 60" white painted Cedar post 1.0' NW of pipe.

Dated October 25, 1957

Restored by

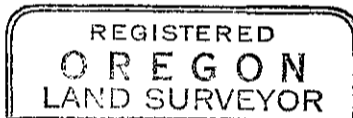

Richard A. Morris

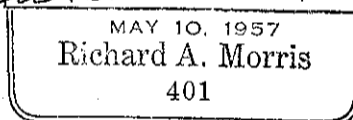

Present and witnessed by Harold Russell
Robert Sturm