

CHAINS

RESTORED CORNER FOR OREGON STATE BOARD OF FORESTRY

Section corner common to Sections 22, 23, 26 and 27, T. 2S., R. 8W., W.M., Tillamook County, Oregon.

ORIGINAL

Stone 18 x 12 x 7 (found in cat road on top of ground 5 ft. from hole in ground which it fit exactly and in which position 4 notches on it face N and 3W. A fourth notch appeared to be broken off W. edge) from which a:

- 5" Hemlock bears S26°W 20 lks.; missing
- 8" Hemlock bears N61°E. 26 lks.; missing
- 8" Hemlock bears N41°W 30 lks.; missing
- 10" Hemlock bears S48°E 50 lks.; missing

NOTE: This area badly burned. Topography N., S., E. & W. is in place.

RESTORED

Var. 21½°

Erected mound of rock around original stone from which a:

42" Fir stub bears S85°E 65.2 ft.; scribed T2S R8W S26 BT RS359.

60" Fir stump bears N83°W 13.1 ft.; scribed T2S R8W S22 BT.

40" Fir stump bears N5°E 84.8 ft.; scribed T2S R8W S23 BT.

24" x 5 ft. Fir stub bears S29°W 31.3 ft.; scribed T2S R8W S27 BT.

Set 4 x 4 x 72" white painted cedar post 1.5 ft. SE of stone.

Oregon State Board of Forestry metal location poster on 42" Fir stub BT.

Dated September 10, 1957

Restored by David Steenson under my direction.

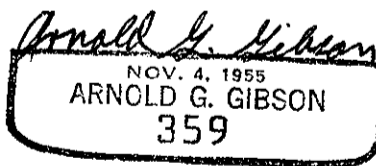
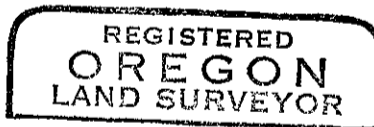

Present and witnessed by Gerald Schwalen
Clarence Skog
Donald Bentz