

CHAINS

M.C. Bet  
Sec 23, 24.  
T.1.S.R.  
10.W.

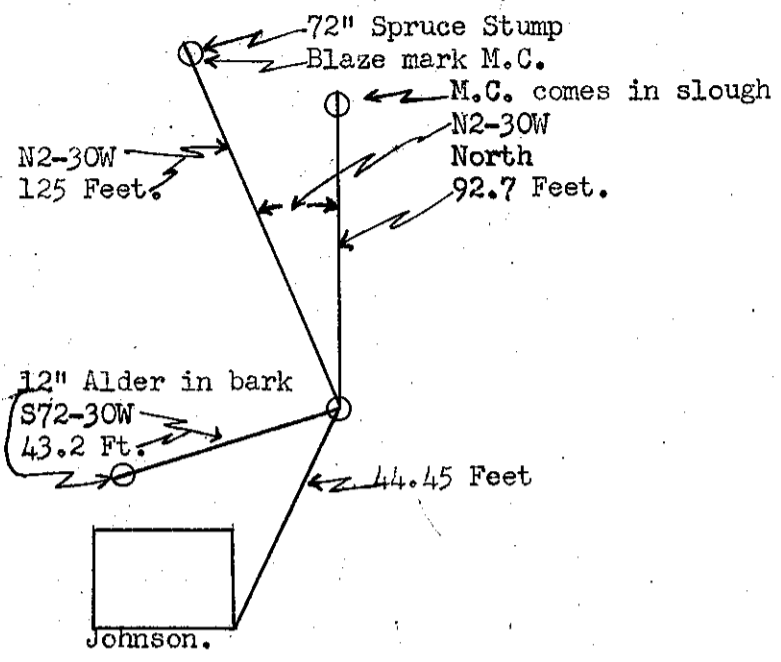

North 885 feet from  $\frac{1}{4}$  Cor  
1" iron pipe beside 2"x 2" lot stake with tack.  
In the year of 1949. W.E. Anderson.

$\frac{1}{4}$  Cor Bet  
Sec 11, 14.  
T.1.N.R.  
10.W.

Found old B.T.s  
Alder 14" with marks in bark.  
Hemlock 16" with marks visible.  
Set new B.T. 18" Hemlock bears S38-W 19.2 Feet.  
Set new B.T. 24" Hemlock bears S4-W 18 Feet.  
Set spruce limb. Aug 22. 1949.

$\frac{1}{4}$  cor on  
the N side  
of sec 6.  
T.2.S.R.9.  
W.

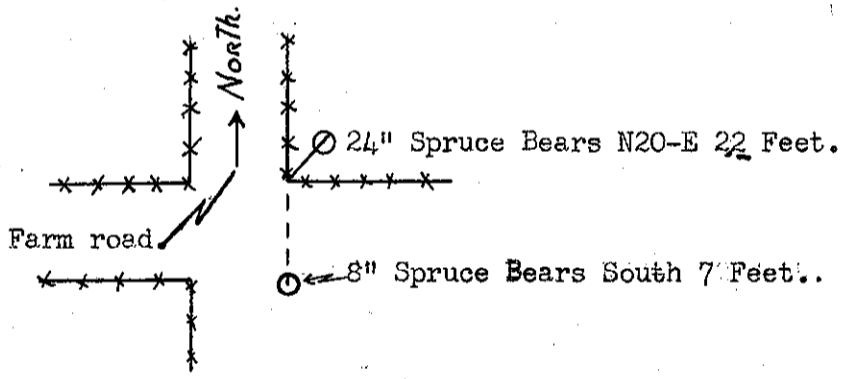

Sec Cor  
to Sec  
35, 36. T.  
S.R.10.W.

