

S/33  
 Compartment 32  
 Sec 32  
 Twp 5 S.  
 R. 8 W.

Log No.	Log Length	Diam. (in)	SPIC CONTENTS BY SPECIES	Diameter (in)	Remarks
1	Chains		Center of section.		
2	19 36	Point for 1/2 cor.			
3		0 dead fir. Subg. N. 262°			
4		Traces of Striding. (old BT)			
5		0 dead fir. Subg. S. W. 108			
6		140 mts. rot fed off			
7	29 36	Set 1/2 cor. for NE. cor.			
8		1 1/2" pipe on si edge of highway # 22			
9		The 1/2 line was run between the two			
0		1/2" S. land.			
1		Feb. 20, 1956.			

Log No.	Log Length	Diam. (in)	SPIC CONTENTS BY SPECIES	Diameter (in)	Remarks
1	Chains		North of railroad line		
2	5 00	Top of spur down to NE.			
3	9 16	Creek 1/2 W. 1/2 N. E.			
4	13 50	Top of spur down to E.			
5	19 50	Creek 1/2 W. wide runs E.			
6	22 50	Top of spur E. 8 W.			
7	39 85	The base cor. bears E. 137			
8		Returned and set stake for 1/2 cor.			
9		at 19. 92' dis. Pasted location top			
0		on 24" fir. MKD 1/2 cor. N. 82° E. 14 Ft.			
1	Chains		From the 1/2 cor.		
2	10 30	Tagged Road line NW 1/4 SE.			
3	17 00	Enter bottom land NW 1/4 SE.			
4	19 35	old cutting line E. 8 W.			
5	22 00	Me skawin creek runs NW			
6	33 24	Fence along S. side of Highway 101			
7	33 82	Yellow L. tie in middle of Highway.			
8	34 10	N. edge of Highway.			
9	39 12	The sec. cor. 4.5 39 82 15 E. 40 LKS.			
0		WEST of trail 1/2 cor. NE. cor. SECTION 8, 9.			
1	Chains		End of line in old cutting.		
2	18 70	Line in old cutting.			
3	Chains		Line in old cutting.		
4	17 20	Enter old cutting.			
5	36 70	Enter old cutting.			
6	40 15	String road N. S. S.			
7	45 60	Tagged road The M. S.			
8	56 25	Trail, N. S. S. (East of 1/2 cor. trail)			
9	56 90	Trail, N. S. S. (East of 1/2 cor. trail)			
0	78 10	Intersect W. bdy. 7 1/2 Ft. N. S. S.			

Where scaled  
 T. 6 S. R. 10 W.  
 Date Jan. 16, 1956

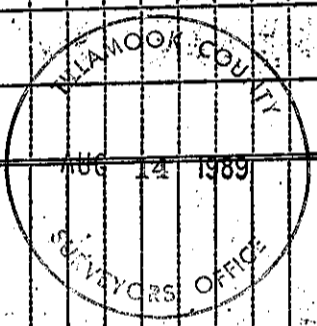

Total scale  
 Number of logs

Total scale  
 Number of logs  
 Scaled by:  
 of the W. S. S. C. R.  
 March 29, 1956