



LESTER E. FULTZ, P.E., P.L.S.

P.O. Box 818

Neskowin, Oregon 97149

503 392-3072

NARRATIVE

This narrative has been prepared to accompany the survey map prepared on Drawing No. S-87160. This drawing represents the results of a field survey of Mae Cronants residence situated in the Southwest one-quarter of the Southeast one-quarter of Section 30, Township 1 South, Range 10 West of the Willamette Meridian, Tillamook County, Oregon.

The work involved the following:

A discussion of Mae Cronant's property as described above was held with Mae Cronant which resulted in her instructions to proceed with the work. The first step was to search the Tillamook County Surveyor's Records for previous surveys. Only two were found, one being the AVALON HEIGHTS subdivision performed by Fultz & Steere, Inc. in 1969 and a survey of Lots 1 & 2, Block 9, AVALON performed in 1977 by J. Carlich. A search was then made for the Carlich monuments and two found as shown on Drawing No. S-87160. Some fresh excavation had been done on Manzanita Street and the monument set by A. Duncan was found. A conversation was held with Allan Duncan concerning his monument and he stated that he had set it at the Northwest corner of Lot 6, Block 10 in connection with work being performed from that point north. Allan Duncan stated that he had tied into the Carlich monument on Manzanita Street and found it sufficiently accurate to be used with his for a basis of bearings. A Topcon Model G2B total station was obtained and a closed traverse made starting at the Northwest corner of Lot 2, Block 9, AVALON, southerly to the Southwest corner of Block 9, AVALON and thence easterly on Grand Avenue to the easement roadway to the Cronant residence, northerly along said roadway to the residence site and thence continuing northwesterly to the Duncan monument on the Northwest corner of Lot 6, Block 10, AVALON. The final survey was then performed with a K & E transit and steel chain to establish the residence tract corners and points along the easement roadway as determined by calculations from the base traverses. All points set were monumented with 1/2-inch iron rods with a yellow cap marked "PLS 1425".

4-5557

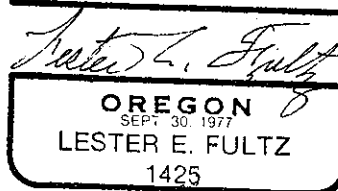
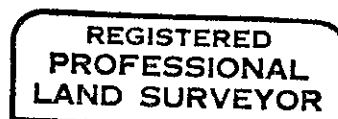
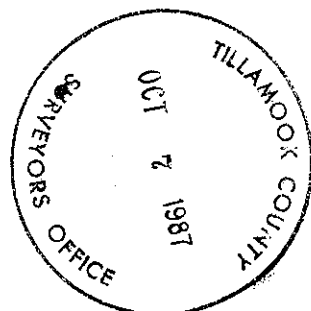

SEE A-5557 FOR MAP

as Duncan, C.S. OCT. 12, 1987