

TOWNSHIP 5 S., RANGE 9 W.W.M. TILLAMOOK CO. ORE.

DATE FEB. 1974

To Castle Rock

31

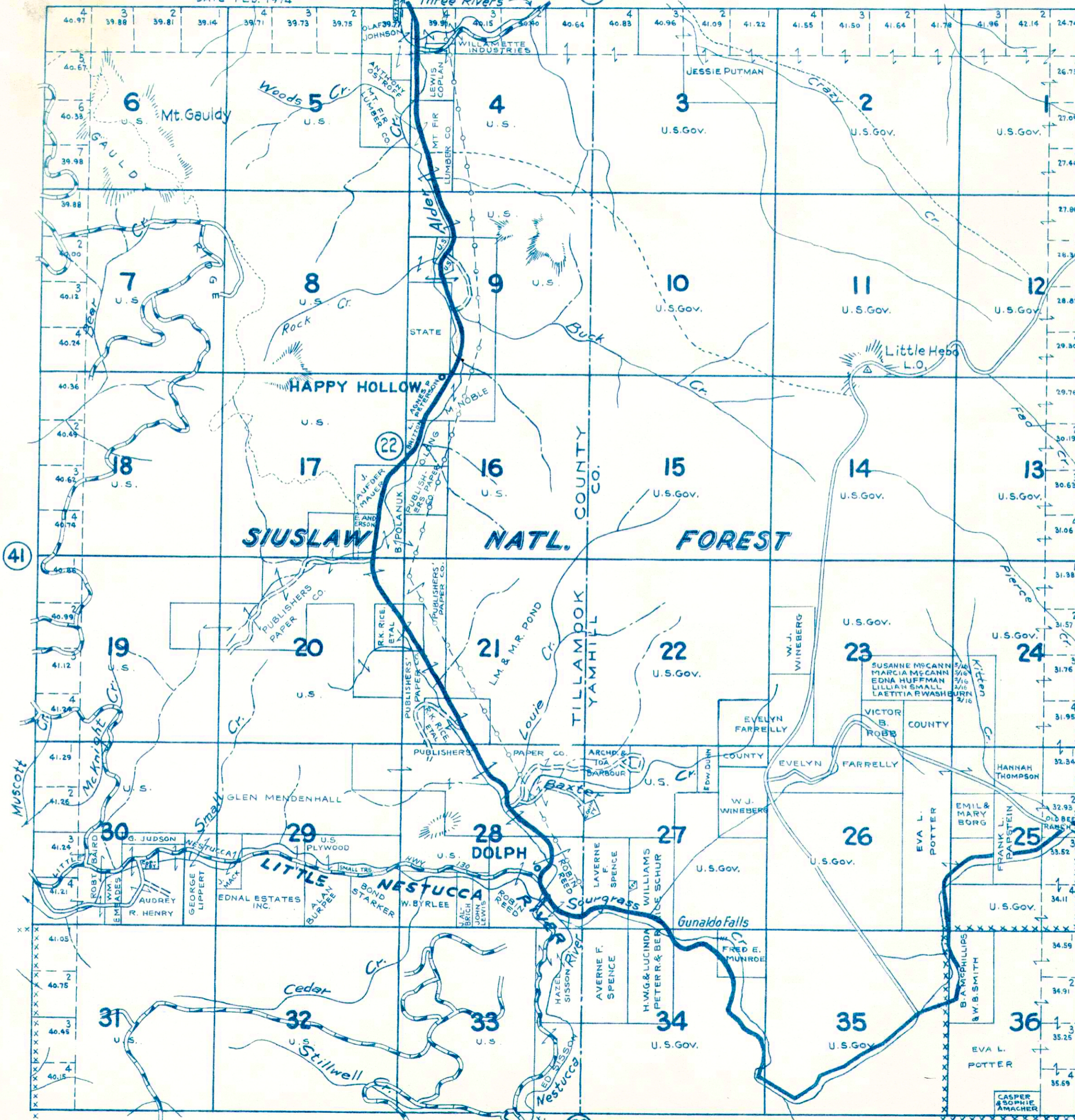

Reproduction in whole
or part for personal use or
resale is prohibited by law.

LEGEND

- STATE HWY. 6 U.S. HWY. 101
- PAVED HIGHWAYS
- IMPROVED DIRT ROADS
- DIRT ROADS
- INFERIOR ROADS
- RAILROADS
- TRAILS
- INTERMITTENT CREEKS
- NAT'L FOREST BDRY. xxxxx
- ELEC. PWR. TRANS. LINES