

TOWNSHIP 4 S., RANGE 7 W.W.M. TILLAMOOK CO. ORE.

TILL. CO. DATED FEB. 1974

16

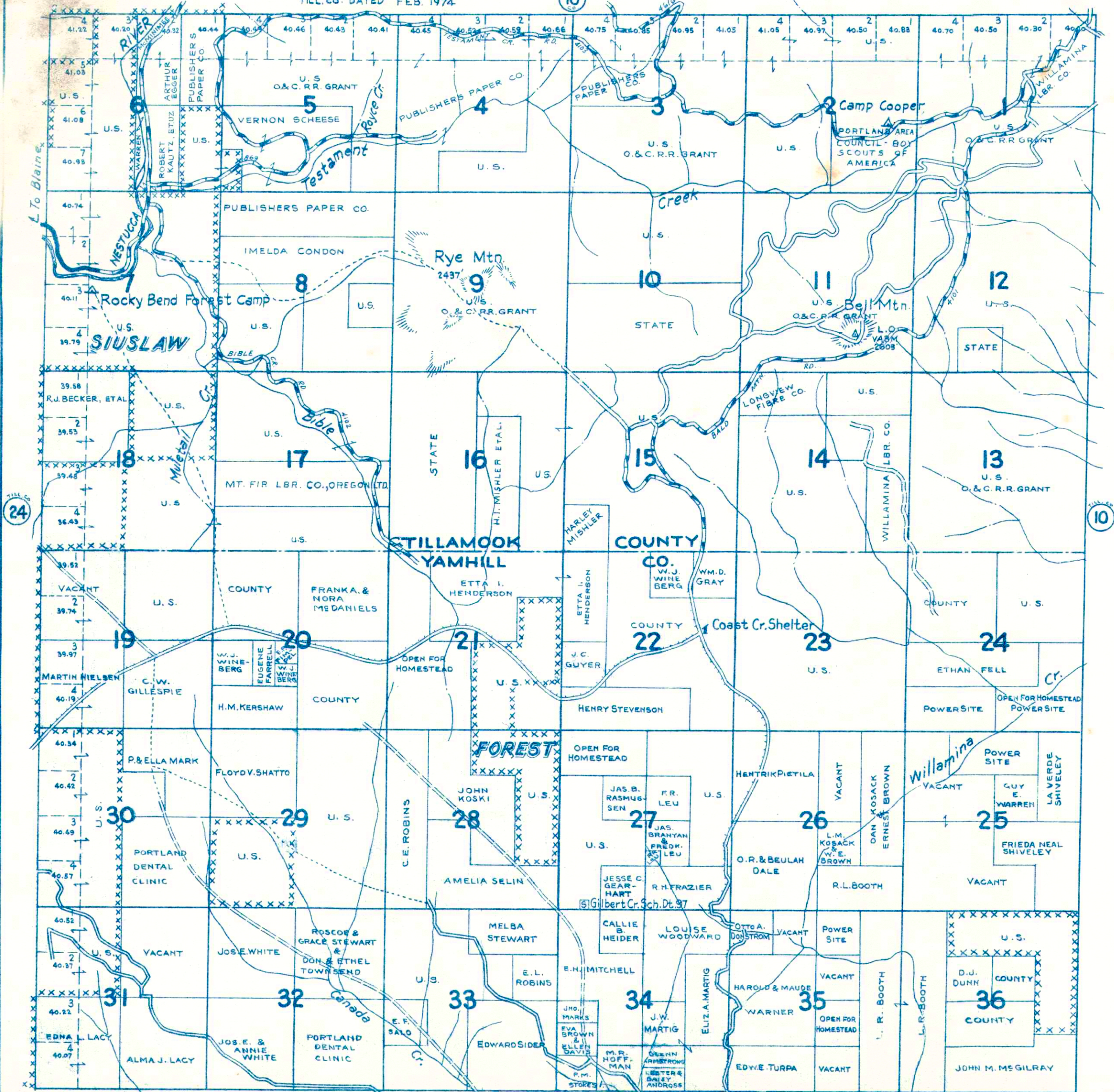

Reproduction in whole
or part for personal use or
resale is prohibited by law.

LEGEND

STATE HWY. 6	U.S. HWY. 101
PAVED HIGHWAYS	—————
IMPROVED DIRT ROADS	——— ———
DIRT ROADS	——— ——— ———
INFERIOR ROADS	——— ——— ——— ———
RAILROADS	——+——+——+——+——
TRAILS	——-——-——-——-——
INTERMITTENT CREEKS	~~~~~
NAT'L FOREST BDY.	xxxxxx
ELEC. PWR. TRANS. LINES	—o—o—o—o—