

# TOWNSHIP 3 N., RANGE 9 W.W.M TILLAMOOK COUNTY ORE.

DATED FEB. 1974

CLATSOP COUNTY

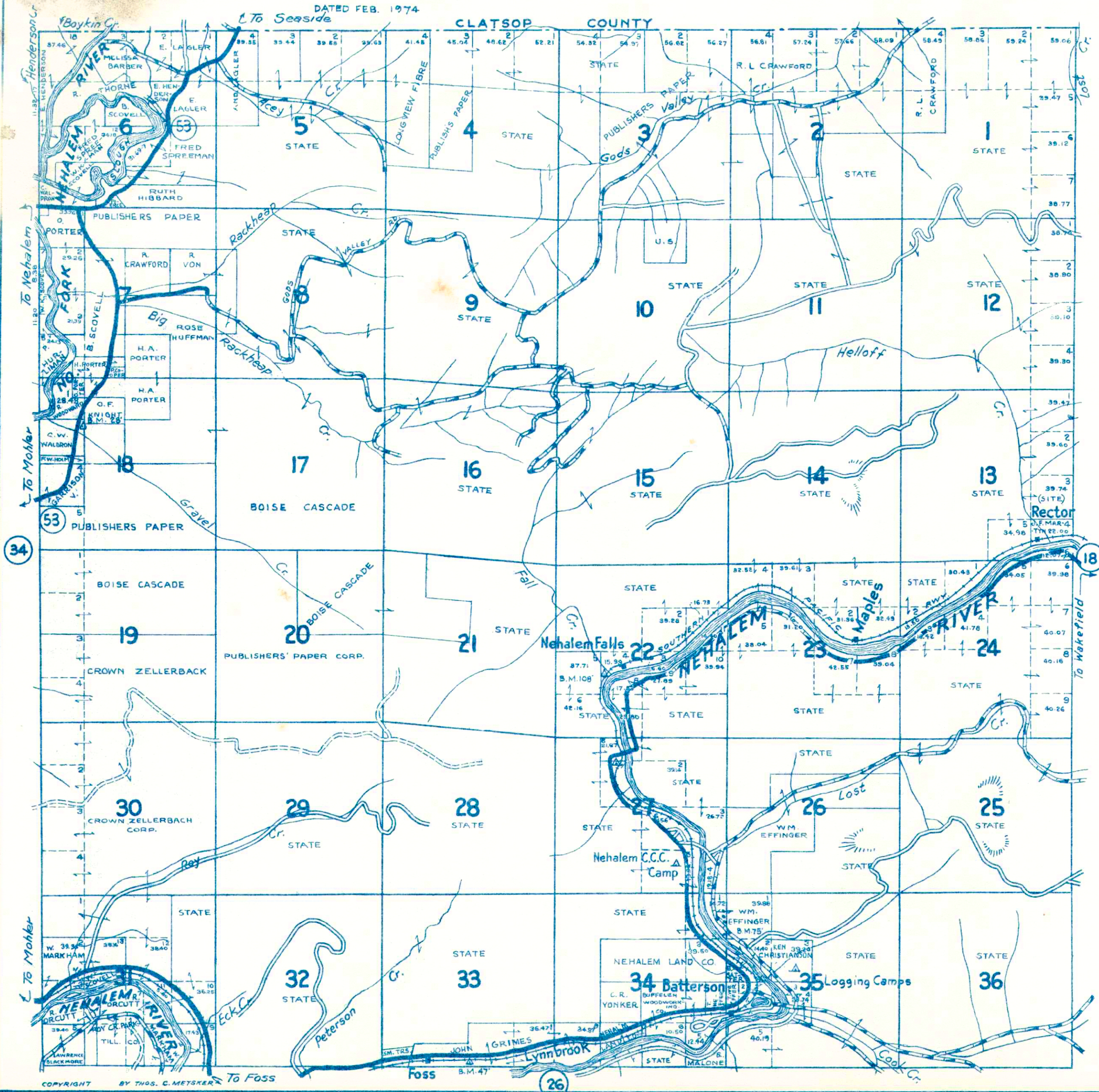

SMALL TRACTS  
 SEC. 35  
 1. O. PORTER  
 2. A.D. LITTLE  
 3. E.C. DILLARD

Reproduction in whole  
 or part for personal use or  
 resale is prohibited by law.

**LEGEND**  
 STATE HWY. (6) U.S. HWY. (101)  
 PAVED HIGHWAYS  
 IMPROVED DIRT ROADS  
 DIRT ROADS  
 INFERIOR ROADS  
 RAILROADS  
 TRAILS  
 INTERMITTENT CREEKS  
 NAT'L FOREST BDYS. XXXXXXXX  
 ELEC. PWR. TRANS. LINES