

# TOWNSHIP 2 S., RANGE 8 W.W.M. TILLAMOOK COUNTY ORE.

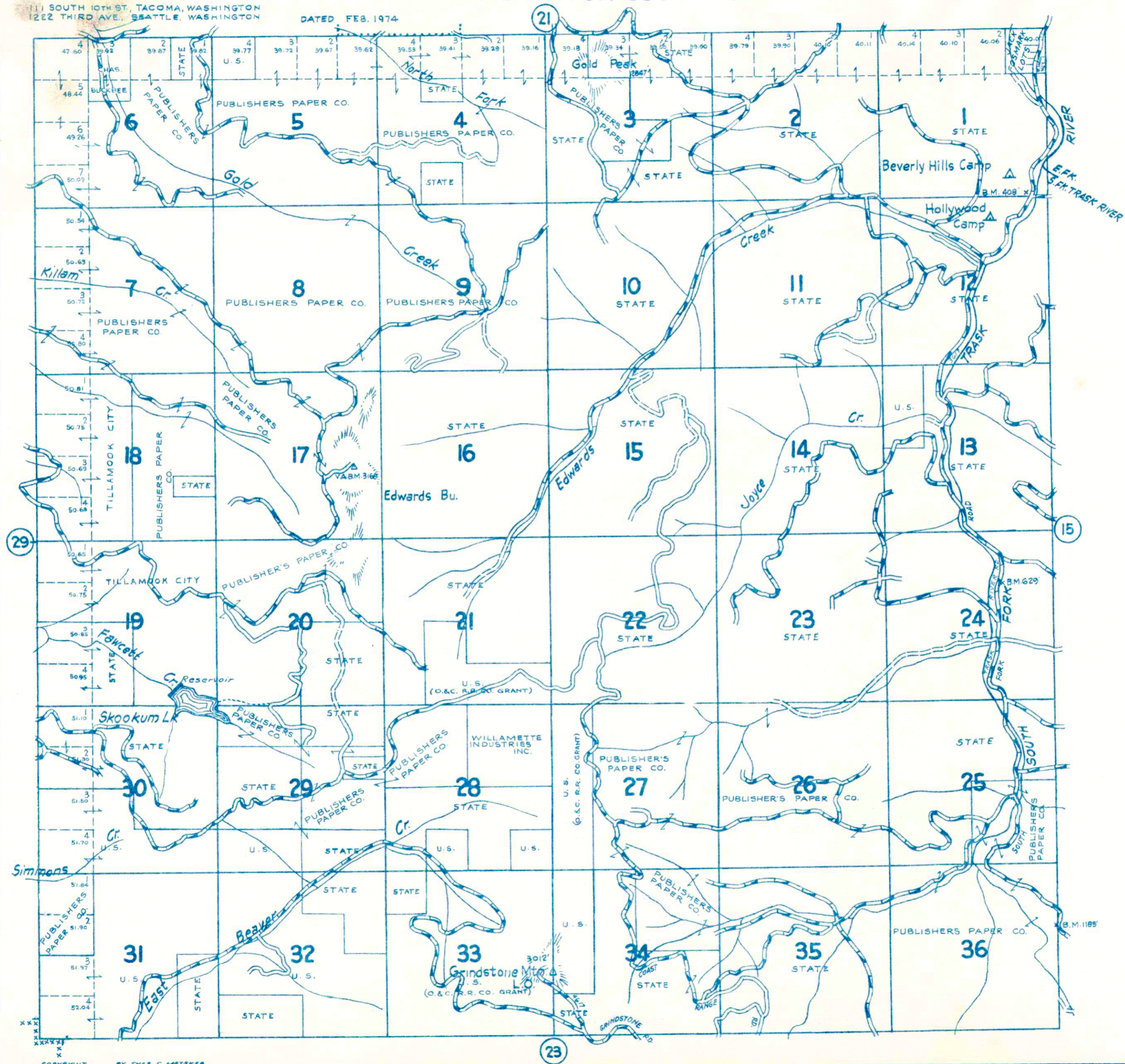

Reproduction in whole  
or part for personal use or  
resale is prohibited by law.

**LEGEND**

- STATE HWY. ⑥ U.S. HWY. 101
- PAVED HIGHWAYS
- IMPROVED DIRT ROADS
- DIRT ROADS
- INFERIOR ROADS
- RAILROADS
- TRAILS
- INTERMITTENT CREEKS
- NAT'L FOREST BDRY. x x x x x
- ELEC. PWR. TRANS. LINES