

TOWNSHIP 2 S., RANGE 7 W.W.M. TILLAMOOK COUNTY ORE.

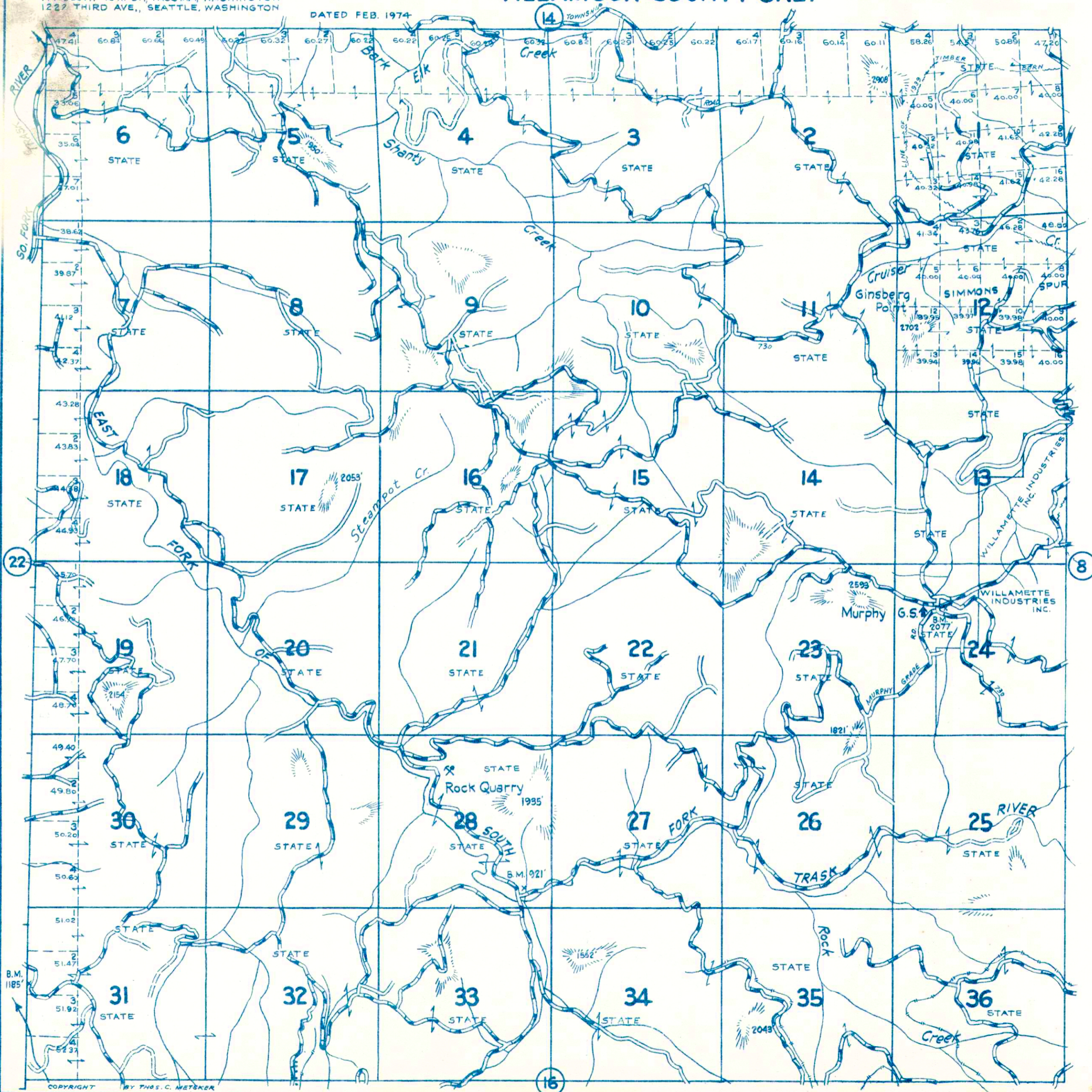

Reproduction in whole
or part for personal use or
resale is prohibited by law.

LEGEND

- STATE HWY. (6) U.S. HWY. (101)
- PAVED HIGHWAYS
- IMPROVED DIRT ROADS
- DIRT ROADS
- INFERIOR ROADS
- RAILROADS
- TRAILS
- INTERMITTENT CREEKS
- NAT'L. FOREST BDY. x x x x x
- ELEC. PWR. TRANS. LINES