

TOWNSHIP 2 S., RANGES 10 & 11 W.W.M. TILLAMOOK COUNTY ORE.

DATED FEB. 1974
NETARTS

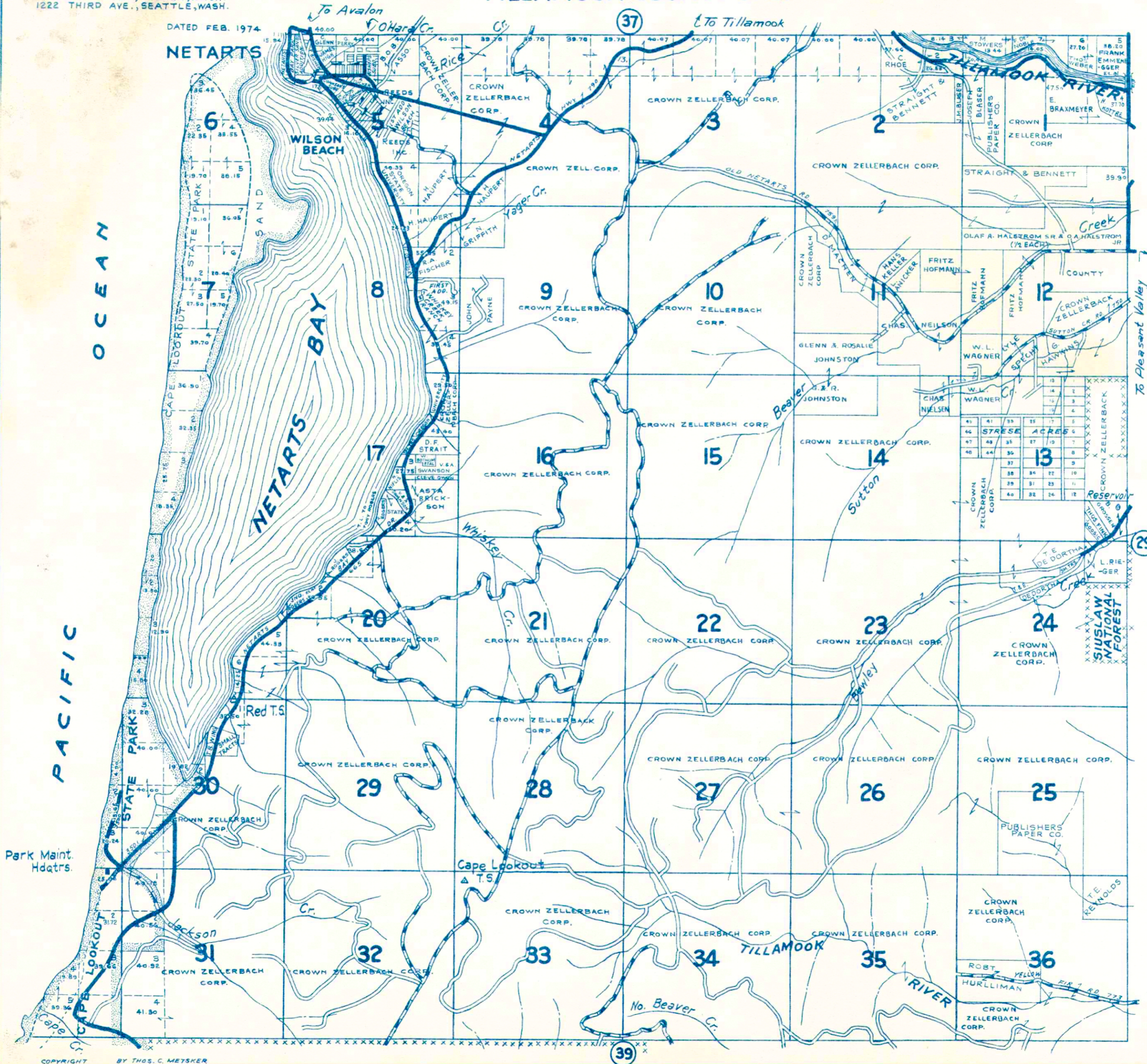

Reproduction in whole or part for personal use or resale is prohibited by law.

- LEGEND**
- STATE HWY. (6) U.S. HWY. (101)
 - PAVED HIGHWAYS
 - IMPROVED DIRT ROADS
 - DIRT ROADS
 - INFERIOR ROADS
 - RAILROADS
 - TRAILS
 - INTERMITTENT CREEKS
 - NAT'L FOREST BDY. (XXXX)
 - ELEC. PWR TRANS. LINES