

TOWNSHIP 2 N., RANGE 10 W.W.M. TILLAMOOK COUNTY ORE.

DATED FEB. 1974

O C C E A N

P A C I F I C

L A K E

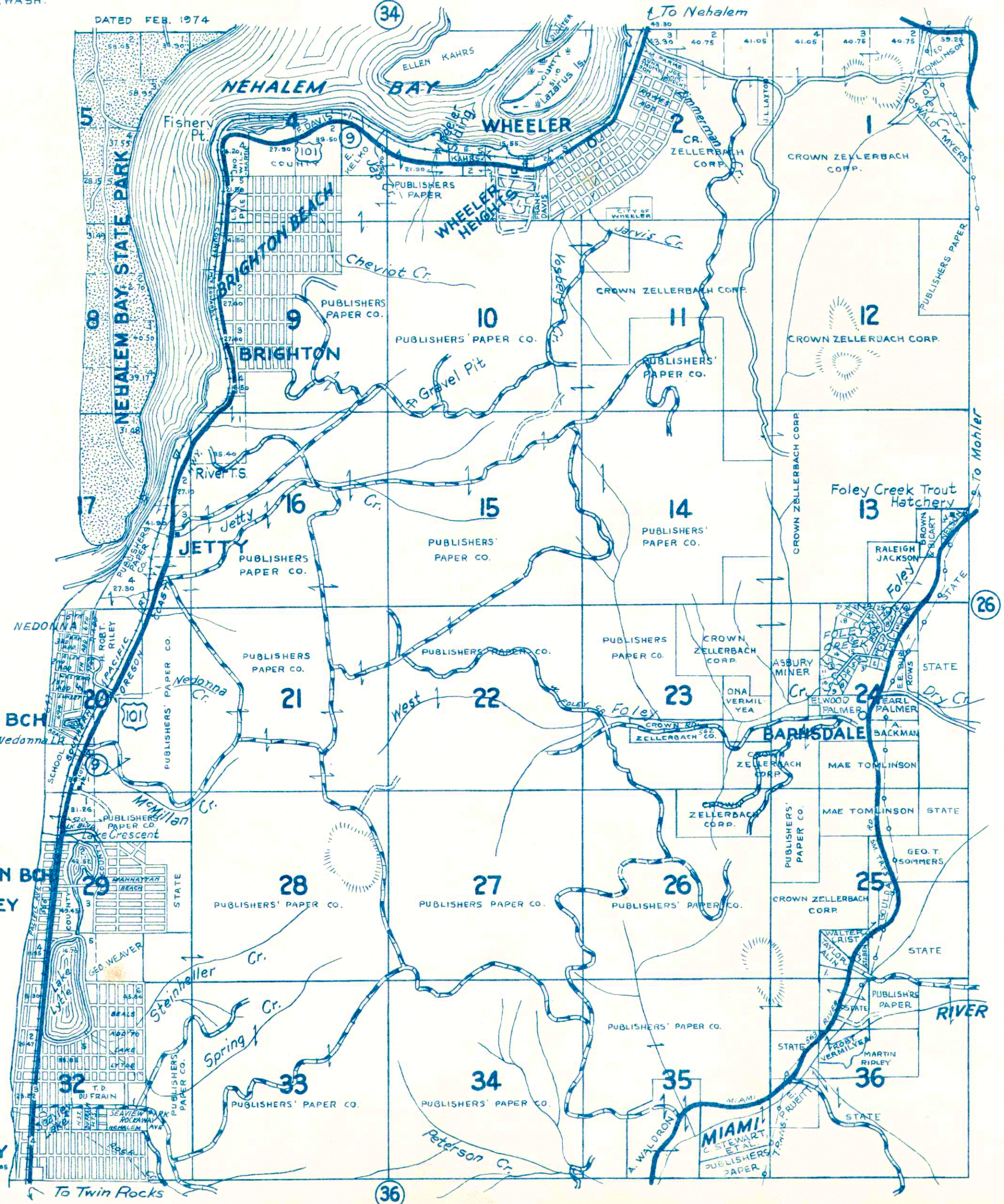

- SMALL TRACTS**
- SEC. 3
 - 1. DICHTER BROS.
 - 2. FRANK DAVIS
 - SEC. 4
 - 1. E. ISERI
 - SEC. 24
 - 1. L. & D. MOORE, ETAL.
 - SEC. 25
 - 1. DENNIS YEAMILYEA

Reproduction in whole
or part for personal use or
resale is prohibited by law.

LEGEND

- STATE HWY. ⑥ U.S. HWY. 101
- PAVED HIGHWAYS
- IMPROVED DIRT ROADS
- DIRT ROADS
- INFERIOR ROADS
- RAILROADS
- TRAILS
- INTERMITTENT CREEKS
- NAT'L FOREST BDRYS XXXXX
- ELEC. PWR. TRANS. LINES