

TOWNSHIP 1 N., RANGE 9 W.W.M. TILLAMOOK COUNTY ORE.

DATED FEB. 1974

(26)

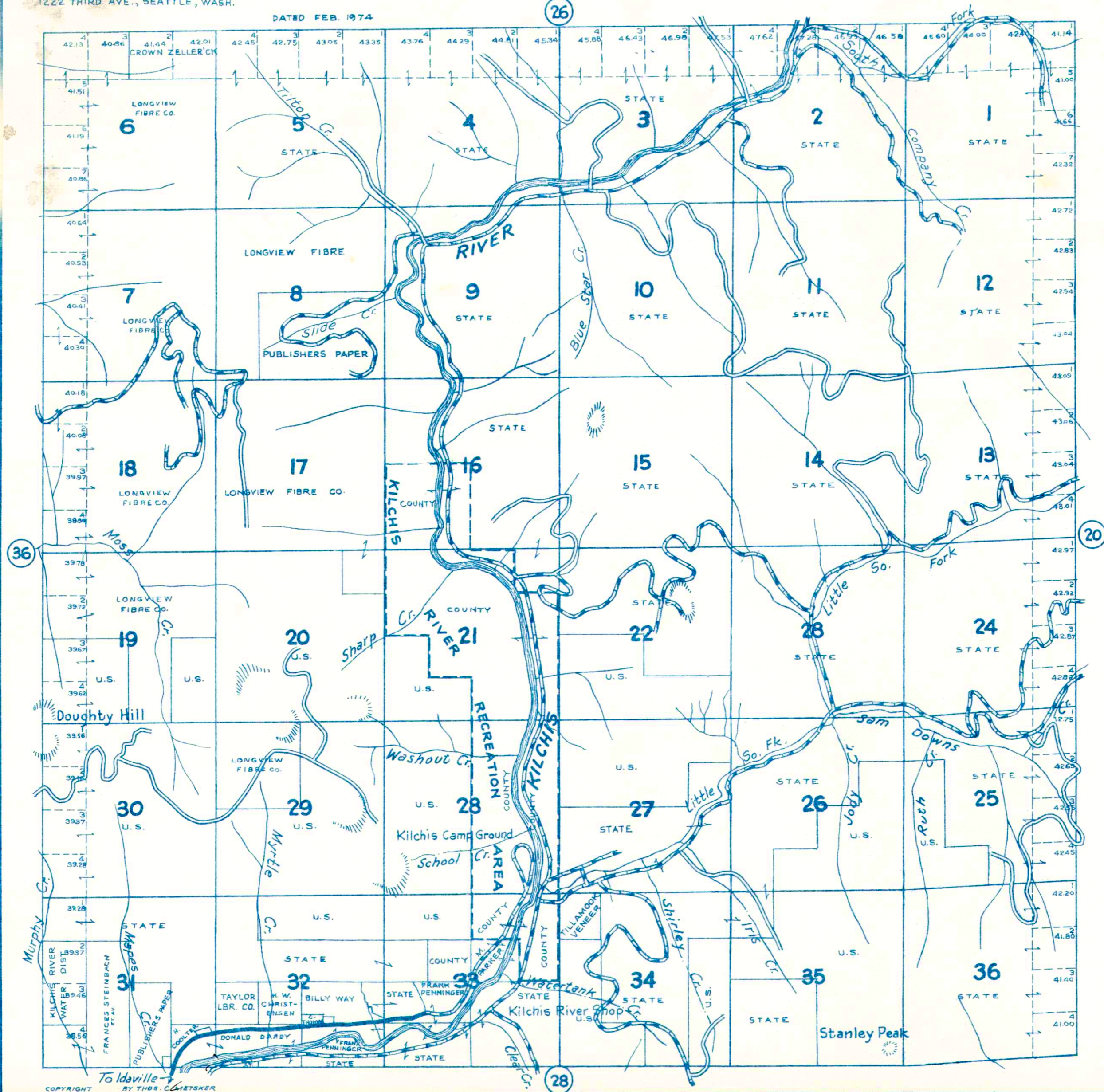

Reproduction in whole
or part for personal use or
resale is prohibited by law.

LEGEND

- STATE HWY. (E) U.S. HWY. (D)
- PAVED HIGHWAYS
- IMPROVED DIRT ROADS
- DIRT ROADS
- INFERIOR ROADS
- RAILROADS
- TRAILS
- INTERMITTENT CREEKS
- NAT'L FOREST BDRYS. XXXXXX
- ELEC. PWR. TRANS. LINES