

TOWNSHIP 6 S., RANGE 11 W.W.M.

TILLAMOOK & LINCOLN CO'S. ORE.

SCALE 2 IN. = 1 MILE

CHAS. F. METSKER CIVIL ENGINEER
514 S.W. OAK ST., PORTLAND, OREGON
111 SO. TENTH STREET, TACOMA, WASH.

41

OCEAN

PACIFIC

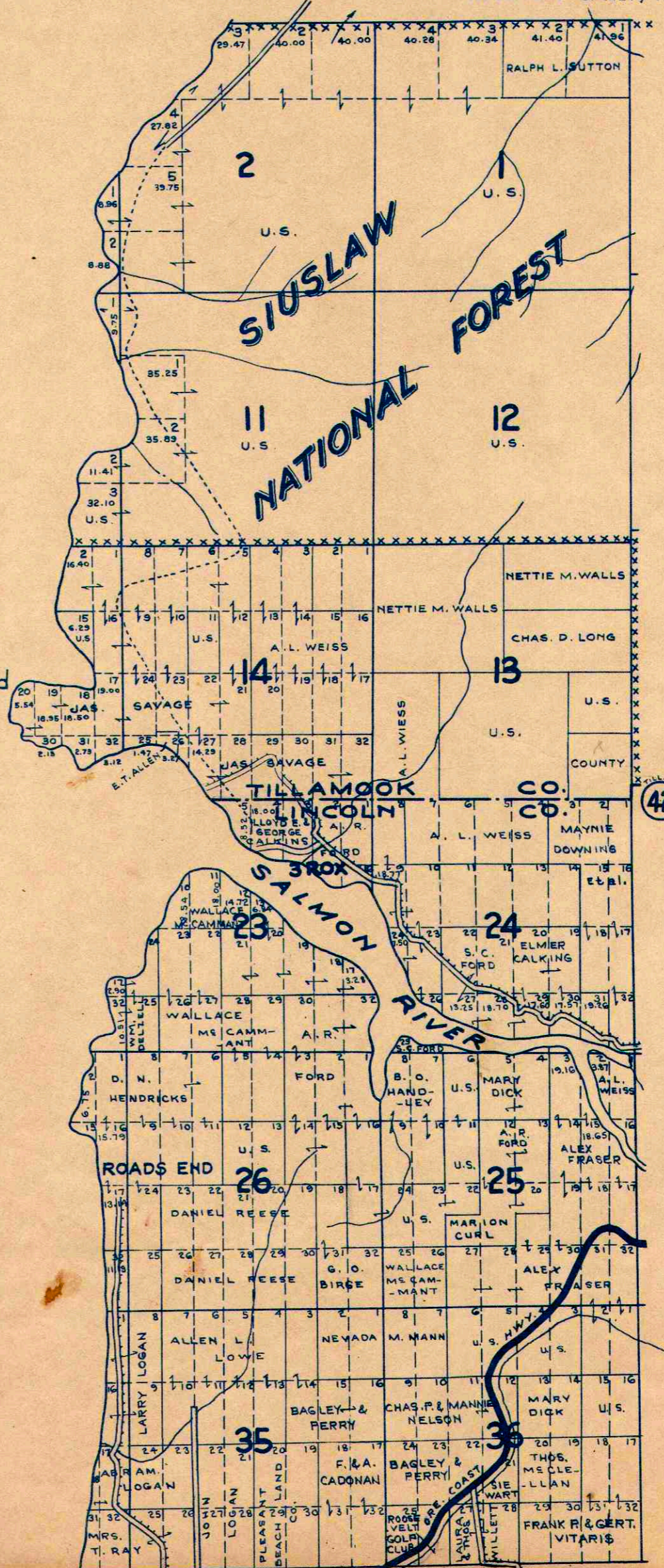

Neshawin

- LEGEND —
- PAVED ROADS
 - IMPROVED DIRT ROADS
 - OTHER ROADS
 - TRAILS
 - RAILROADS
 - ELE. RWYS.
 - SCHOOLS