

Center Sec. Cor.  
**Sec. 6.**

**Plat of Change in County Road  
 from Dunstan's to Blumis.  
 Tp. 5. S. R. 9. W.  
 Length - 1053.6 Ft.  
 GREEN TIMBER ROAD**

**T. E. Epplert**

**HENRY AND MARY  
 DURSTAN**

**F. R. BEALS**

1367107

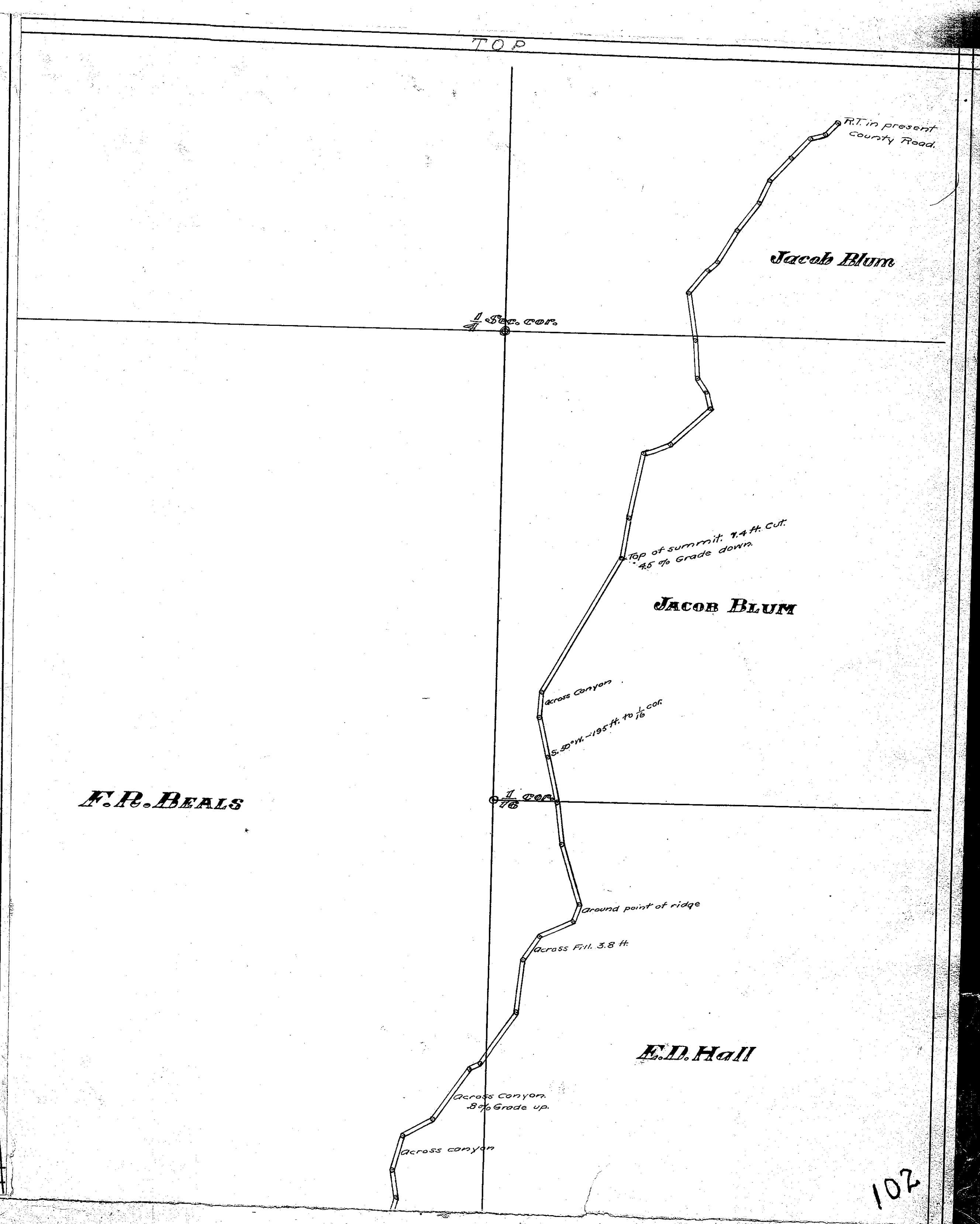

TOP

1/4 Sec. cor.

1/4 Sec. cor.

**Jacob Blum**

**JACOB BLUM**

**E. D. Hall**

102