

Map showing corners on the line between Sections 23 & 26 T₃ N, R. 10. W
Will, Mer, Oregon, by US Engineer. J.D. Edwards County Surveyor and
A.M. Austin

In presence of William Tohl, A.J. Cloutrie and
W.H. Tubising in 1890 by J.D. Edwards NO 1

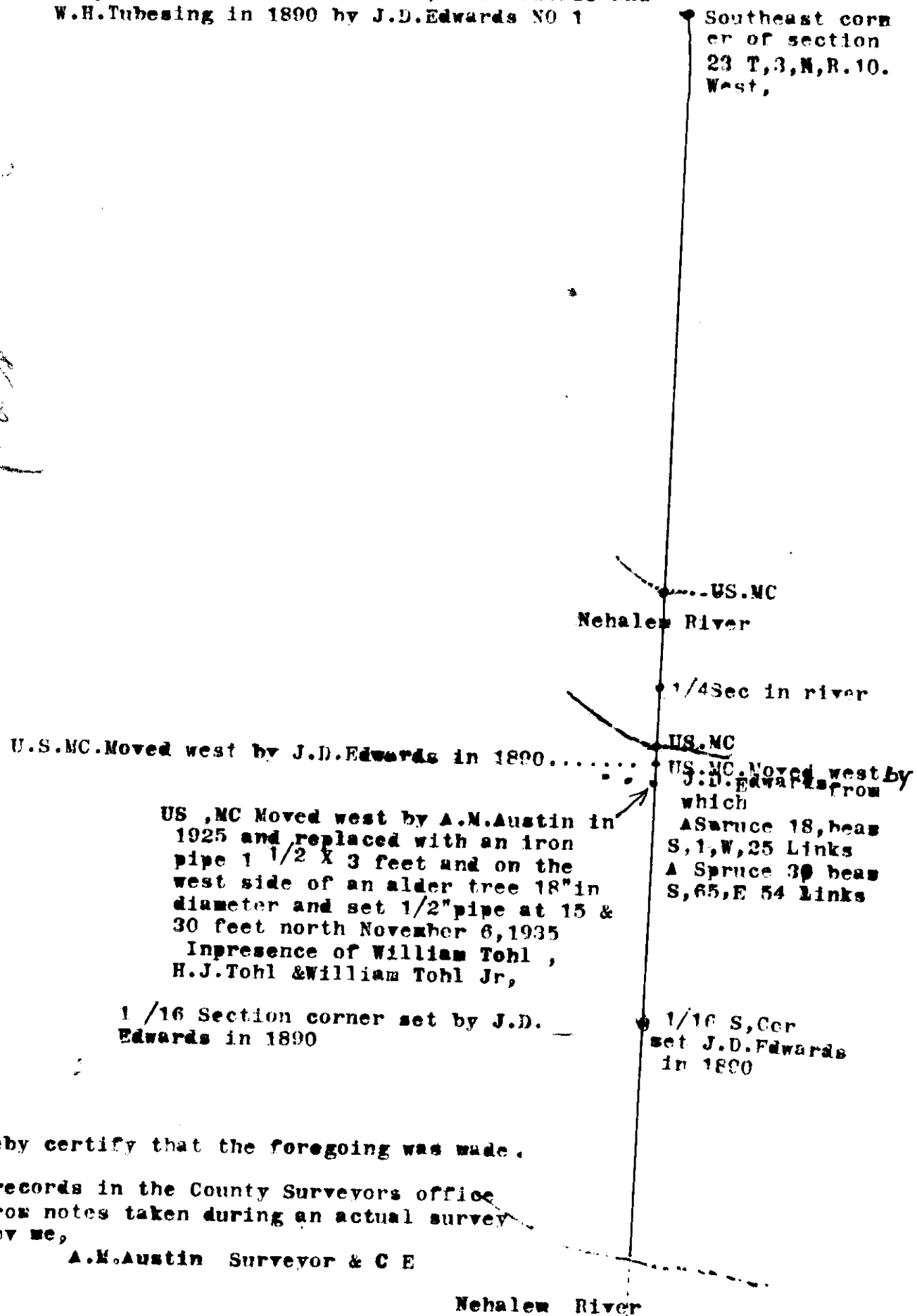

F 289
23/26/3 N 10



I Hereby certify that the foregoing was made.

from records in the County Surveyors office
and from notes taken during an actual survey
made by me,

A.M. Austin Surveyor & C E

Nehalem River