

← NORTH STREETS — SOUTH STREETS →

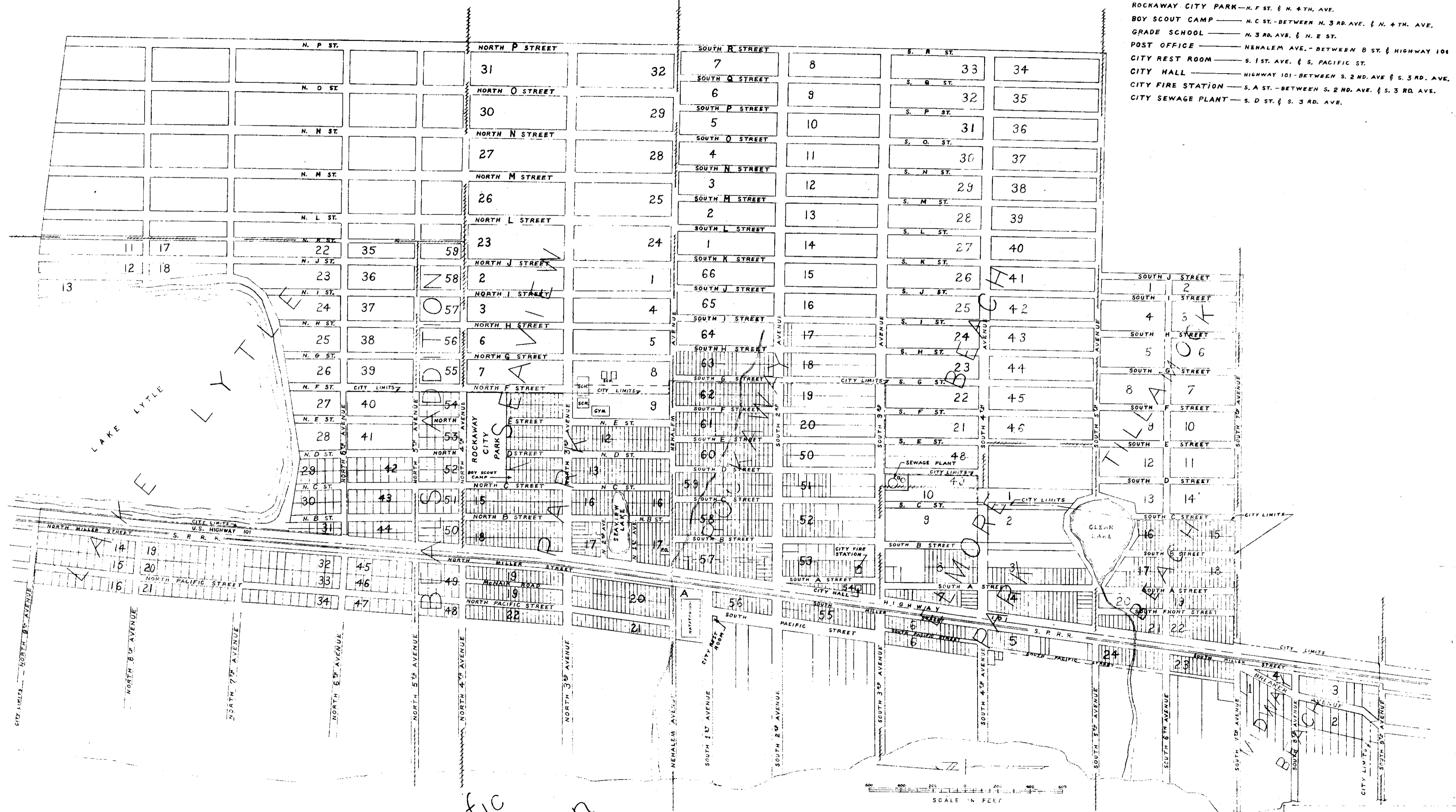

- ROCKAWAY CITY PARK — N. F ST. & N. 4TH. AVE.
- BOY SCOUT CAMP — N. C ST. — BETWEEN N. 3RD. AVE. & N. 4TH. AVE.
- GRADE SCHOOL — N. 3RD. AVE. & N. E ST.
- POST OFFICE — NEHALEM AVE. — BETWEEN B ST. & HIGHWAY 101
- CITY REST ROOM — S. 1ST. AVE. & S. PACIFIC ST.
- CITY HALL — HIGHWAY 101 — BETWEEN S. 2ND. AVE & S. 3RD. AVE.
- CITY FIRE STATION — S. A ST. — BETWEEN S. 2ND. AVE. & S. 3RD. AVE.
- CITY SEWAGE PLANT — S. D ST. & S. 3RD. AVE.

Pacific Ocean

———— PLATTED AREA BOUNDARY  
 - - - - - CITY LIMITS

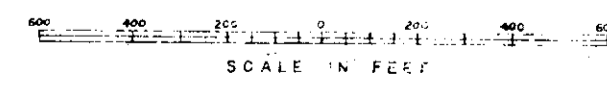

F-40-200

**ROCKAWAY CITY  
STREETS  
AND  
PLATTED AREAS**  
 JULY 1958  
 G. J. WOOD